

VEMA

together for the future

GIROD INSTRUMENTS

GIROD-TAST



WWW.VEMA.CN

测量仪器
工程设计



瑞士基诺德仪器:

杠杆刻度指示表

在瑞士汝拉地区的心脏地带，Girod公司为客户提供服务，开发适合他们需求的测量仪器。

无论您的需求是什么，基诺德充满活力的团队将专门为您开发所需的仪器，即使是少批量的。

作为微机械领域的专家，该公司开发了自己的杠杆表：Girod-Tast。不要忘记正确使用它所必需的配件。

从生态的角度来看，Girod Instruments还在自己的场所提供产品维修服务。

Girod Instruments:

一个长期的合作伙伴。

瑞士原装



Girod-Tast杠杆指示器是经过验证的，高可靠性和精心设计的仪器。瑞士制造的Girod-Tast产品对磁场不敏感，并以其高灵敏度、精度和稳定的重复性而闻名。它们有多种版本，基诺德提供快速维修服务。

让你对质量感到惊讶吧。

有能力的伙伴

在基诺德，您不仅可以找到一个销售部门，还可以找到有能力的合作伙伴，他们可以回答您的问题，帮助您开发您的产品。我们重视与客户的直接和个人联系，我们愿意为他们分担任务和责任。

自1964年以来，我们的家族企业已经在机械测量仪器市场上建立了自己的地位，并为最大的品牌提供OEM服务。

我们的测量仪器是经过验证的，高可靠性和精心设计的仪器。

让我们的专家为您提供建议！

Lever-type dial indicators

Girod Instruments is located in Court, in the middle of the Swiss Jura. The company develops **measuring instruments** which are adapted to the needs of their customers.

Whatever the requests are, the dynamic team in **Girod Instruments Sàrl** will create specific instruments requested by their customers, even in- small quantities.

Specialist in micro-mechanic, the enterprise has developed its own lever indicator : **the Girod-Tast**. The accessories for a good use of this product are also available. From an ecological perspective, **Girod Instruments** manages the repairs of the products directly within its own locations.

Girod Instruments:

a partner for a long time.

Swiss Made



The lever-type dial indicators of Girod-Tast are tested, highly reliable and have a very neat appearance. The products of Swiss Made Girod-Tast are unaffected by magnetic fields and are renowned by their high sensitivity, the precision and the fidelity on long term. They are available in several versions and Girod Instruments provides an insured maintenance and a fast service.

Let you surprised by the quality.

competent partners

Girod Instruments is not only a sales department, there are also competent partners who are able to answer your questions in order to help you to develop your products. We favour direct and private contacts with our customers for whom we are ready to share the tasks and responsibilities.

Since 1964 our family business has a foothold in the measuring instruments market and holds a very important place the outsourcing of largest brands.

Our **measuring instruments** are tested, highly reliable and have a very neat appearance.

Let our specialists advise you!



NEW

● GT 1456



● GT 2253



● GT 2453

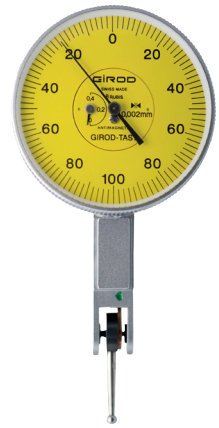

● GT 4462

XL



● GT 4464

XXL



型号 Type	精度 Reading mm.			测量范围 Range mm.							显示类型 Type			表盘 Dial mm.		探针长度 Length of stylus L mm.						
	0,01	0,001	0,002	2	4	1,6	0,8	0,5	0,4	0,2	0,14	水平 horizontal	垂直 vertical	纵向 longitudinal	Ø 27,4	Ø 37	12	18	24	36	38	
GT 1456		●									●	●			●	●	●					
GT 2253			●					●				●			●		●					
GT 2453			●					●				●			●		●					
GT 4462	●			●								●			●			●				
GT 4464	●				●							●			●							●

WWW.VEMA.CN

杠杆式刻度盘标配

LEVER TYPE DIAL INDICATOR STANDARD

● GT 1252



● GT 1452



● GT 1253



● GT1453



● GT 1254



● GT 1454

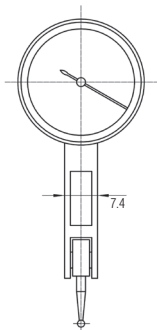
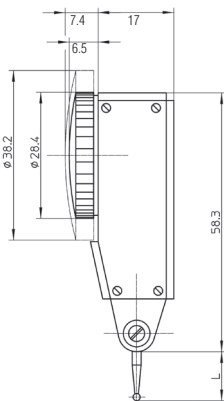

WWW.VEMA.CN

型号 Type	精度 Reading mm.			测量范围 Range mm.					显示类型 Type			表盘 Dial mm.		探针长度 Length of stylus L mm.			
	0,01	0,001	0,002	1.6	0.8	0.5	0.4	0.2	0.14	水平 horizontal	垂直 vertical	纵向 longitudinal	Ø 27.4	Ø 37	12	24	36
GT 1252	●				●					●			●				
GT 1452	●				●					●			●				
GT 1253		●						●		●			●		●		
GT 1453		●						●		●			●		●		
GT 1254	●					●				●			●				●
GT 1454	●					●				●			●				●

指示标尺垂线
杠杆式刻度盘垂直指示

● GT 1272



● GT 1472



● GT 1273



● GT 1473



● GT 1274



● GT 1474

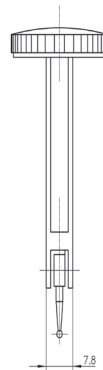
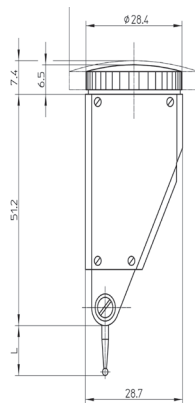

WWW.VEMA.CN

型号 Typ	精度 Reading mm.			测量范围 Range mm.					显示类型 Type			表盘 Dial mm.		探针长度 Length of stylus L mm.			
	0,01	0,001	0,002	1.6	0.8	0.5	0.4	0.2	0.14	水平 horizontal	垂直 vertical	纵向 longitudinal	Ø 27.4	Ø 37	12	24	36
GT 1272	●				●						●		●		●		
GT 1472	●				●						●			●	●		
GT 1273	●		●					●			●		●		●		
GT 1473			●					●			●			●	●		
GT 1274					●						●		●				●
GT 1474	●				●						●			●			●

杠杆式纵向刻度盘指示

LEVER TYPE DIAL INDICATOR LONGITUDINAL

● GT 1292



● GT 1492

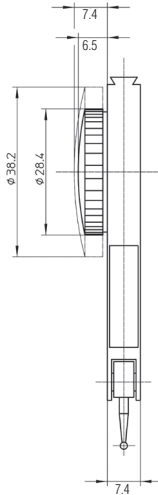

● GT 1293



● GT 1493

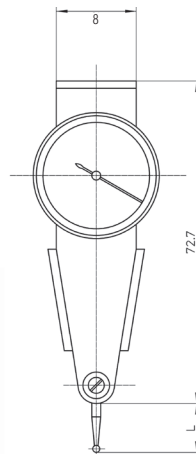

● GT 1294



● GT 1494



WWW.VEMA.CN

型号 Type	精度 Reading mm.			测量范围 Range mm.					显示类型 Type			表盘 Dial mm.		探针长度 Length of stylus L mm.			
	0,01	0,001	0,002	1.6	0.8	0.5	0.4	0.2	0.14	水平 horizontal	垂直 vertical	纵向 longitudinal	Ø 27.4	Ø 37	12	24	36
GT 1292	●				●							●	●		●		
GT 1492	●				●							●	●		●		
GT 1293			●					●				●	●		●		
GT 1493			●					●				●	●		●		
GT 1294	●				●							●	●				●
GT 1494	●				●							●	●				●

杠杆式刻度盘双量程指示 LEVER TYPE DIAL INDICATOR DOUBLE RANGE

● GT 2252



● GT 2452



● GT 2272



● GT 2472



WWW.VEMA.CN

型号 Type	精度 Reading mm.			测量范围 Range mm.						显示类型 Type			表盘 Dial mm.		探针长度 Length of stylus L mm.		
	0,01	0,001	0,002	1,6	0,8	0,5	0,4	0,2	0,14	水平 horizontal	垂直 vertical	纵向 longitudinal	Ø 27.4	Ø 37	12	24	36
GT 2252	●			●						●			●			●	
GT 2452	●			●						●				●		●	
GT 2272	●			●							●		●			●	
GT 2472	●			●							●			●		●	

7

套装 SET GIROD-TAST

● GT.3963.1252

带有磁性支架的GIROD-TAST系列
组成：

- 1 GIROD-TAST 水平杠杆表 GT 1252
- 1 带磁性底座的旋转支架 GT.3942
- 1 圆柱形柄 GT.3914
- 1 探针更换工具 GT.3876
- 1 木盒 GT.3965

**Set GIROD-TAST with swivel support with magnetic base
Equipment comprising set :**

- 1 GIROD-TAST horizontal GT 1252
- 1 Swivel support with magnetic base GT.3942
- 1 Cylindrical shank GT.3914
- 1 Key for contact point GT.3876
- 1 Wooden box GT.3965



● GT.3962.1272

GIROD-TAST系列与中心支架
组成：

- 1 GIROD-TAST 垂直杠杆表 GT 1272
- 1 定心支撑 GT.3934
- 1 圆柱形柄 GT.3914
- 1 探针更换工具 GT.3876
- 1 木盒 GT.3964

**Set GIROD-TAST with centring support
Equipment comprising set :**

- 1 GIROD-TAST vertical GT 1272
- 1 Centring support GT.3934
- 1 Cylindrical shank GT.3914
- 1 Key for contact point GT.3876
- 1 Wooden box GT.3964



提高指标

主要特点

- 高灵敏度·精度和重复保真度(见DIN 2270和Girod标准)。
- 经过试验和测试的设备·具有高可靠性和良好的外观。
- 对磁场不敏感。
- 自动反转触点·持续顺时针旋转。
- 易于阅读和消除错误·将针的行程限制在一圈。
- 可调节的表圈和表盘。
- 完全独立和可互换的机芯·方便快捷地拆卸和更换维修。
- 坚固的一体式外壳·配有3个燕尾榫:顶部、后部和前部;采用镀铬耐腐蚀。
- 接触点旋转支持在精密球轴承。
- 为通用应用而设计·非常适合车间使用。
- 可互换硬质合金接触点旋转超过240°。

众多型号可供选择:

- 水平·垂直和纵向
- 大直径和小直径表盘
- 硬质合金接触点12mm或36mm长度公制读数0,01 mm或0,001和0,002 mm *
英寸读数·0005 "或·0001 "
- 质保和快速维修服务。
- 每件Girod Tast均以木盒的形式提供
1个探针更换工具和1个ø8毫米的圆柱形柄。
- 配件种类繁多。

*提供相应型号的信息。

Special features

- High sensitivity, repeatability and accuracy. All Girod-Tast indicators meet or exceed Federal or DIN specifications or other national standards.
- All Girod-Tast indicators have proven reliability, durability and modern design features.
- Unaffected by magnetic fields.
- Automatic reversing contact point, with constant clockwise rotation.
- Easy and error-free reading by only one revolution of the hand.
- Adjustable bezel and dial.
- Fully jeweled, completely independent and interchangeable movement. Easily and quickly removed and replaced for maintenance.
- Rugged one-piece housing provided with 3 dovetails: top, back and front; corrosion resistant with satin chrome finish.
- Contact point swivel supported in precision ball bearings.
- Designed for universal applications. Well-suited for workshop use.
- Interchangeable carbide contact point swivels over 240°.

Many models available:

- horizontal, vertical and longitudinal
- large and small diameter dial
- carbide contact point 12 mm or 36 mm length
metric reading 0,01 mm or 0,001 and 0,002 mm
*inch reading .0005" or .0001"
- Warranted and rapid maintenance service.
- Each Girod-Tast is supplied in fitted case with
1 key for contact points and 1 dovetail stems
ø 8 mm.
- Accessories.
*Full catalogue and information in inch models
are available.

杠杆式表盘

刻度盘仪表 DIAL GAUGES

我们的精密千分表系列经过深思熟虑的设计、精确的组件和坚固的结构，具有可靠性、耐用性和长使用寿命。

作为不断改进我们产品的一部分，我们保留在不事先书面通知的情况下修改我们产品的设计、技术规格或标准的权利。

这些页面上展示的产品都有一个防震装置，可以有效地保护它们免受冲击杆造成的损坏。杆上的冲击不会直接传递到机构。

The well thought-out design, accurate components and robust construction of our Precision Dial Gauge series offer reliability, durability and long working life.

The standard features that enhance the quality across our entire product range are. Materials and components selected specifically to ensure a long working life.

● GT 66102

Lecture **0,01 mm**
Course **10 mm**
Ø extérieur **58 mm**

Reading **0,01 mm**
Range **10 mm**
Bezel-Ø **58 mm**



● GT 66102 AC

Antichoc
Lecture **0,01 mm**
Course **10 mm**
Ø extérieur **58 mm**
avec capuchon de protection vissé

Shockproof
Reading **0,01 mm**
Range **10 mm**
Bezel-Ø **58 mm**
with threaded protective sleeve



小刻度盘仪表 SMALL DIAL GAUGES

● GT 63032

Lecture **0,01 mm**
Course **3 mm**
Ø extérieur **32 mm**

Reading **0,01 mm**
Range **3 mm**
Bezel-Ø **32 mm**

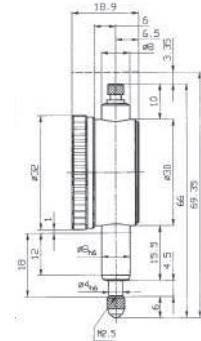

● GT 64032

Lecture **0,01 mm**
Course **3 mm**
Ø extérieur **40 mm**

Reading **0,01 mm**
Range **3 mm**
Bezel-Ø **40 mm**



小刻度盘仪表 SMALL DIALS GAUGES

● GT 64052

Lecture **0,01 mm**
Course **5 mm**
Ø extérieur **40 mm**

Reading **0,01 mm**
Range **5 mm**
Bezel-Ø **40 mm**

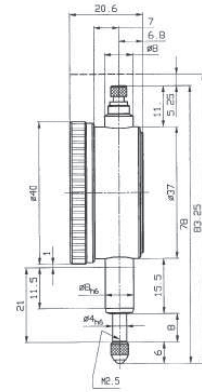

● GT 64032 AC

Antichoc
Lecture **0,01 mm**
Course **3 mm**
Ø extérieur **40 mm**
avec capuchon de protection vissé

Shockproof
Reading **0,01 mm**
Range **3 mm**
Bezel-Ø **40 mm**
with threaded protective sleeve

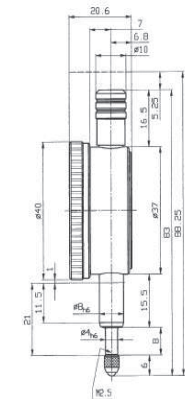

小刻度盘仪表 SMALL DIAL GAUGES

● GT 66016 AC

Antichoc

Lecture **0,001 mm**
Course **1 mm**
Ø extérieur **58 mm**
avec capuchon de protection vissé

Reading **0,001 mm**
Range **1 mm**
Bezel-Ø **58 mm**
with threaded protective sleeve

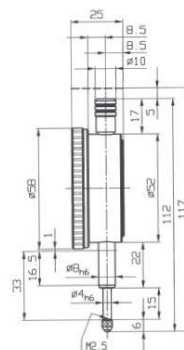

● GT 66012 S

Étanche et antichoc

Lecture **0,01 mm**
Course utile **1 mm**
Course libre **9 mm**
Ø extérieur **61,5 mm**
avec capuchon de protection vissé

Waterproof, shockproof

Reading **0,01 mm**
Range **1 mm**
Overtravel **9 mm**
Bezel-Ø **61,5 mm**
with threaded protective sleeve

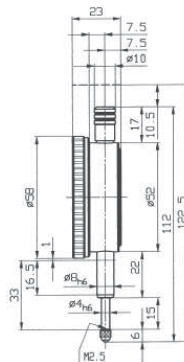
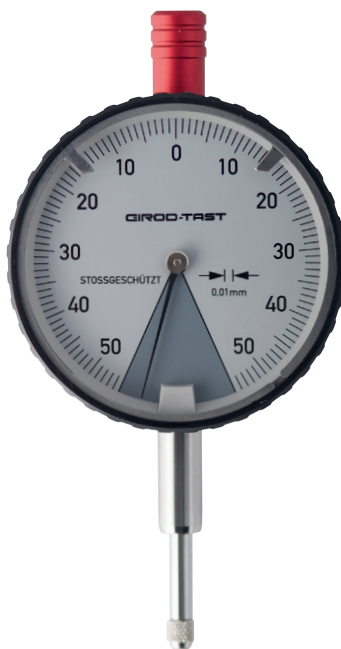

小刻度盘仪表 SMALL DIALS GAUGES

● GT 64032 E

Etanche et antichoc
Lecture **0,01 mm**
Course **3 mm**
Ø extérieur **44,5 mm**

Waterproof, shockproof
Reading **0,01 mm**
Range **3 mm**
Bezel-Ø **44,5 mm**

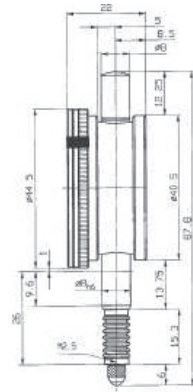

● GT 66102 E

Etanche et antichoc
Lecture **0,01 mm**
Course **10 mm**
Ø extérieur **61,5 mm**

Waterproof, shockproof
Reading **0,01 mm**
Range **10 mm**
Bezel-Ø **61,5 mm**

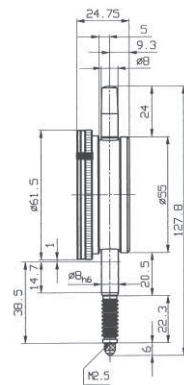

高精度比较仪

HIGH PRECISION COMPARATOR GAUGES

高精度比较仪具有高度的安全性和精度。它们基于考虑到最新技术的坚实而深思熟虑的结构。

它们是用迄今为止最先进的方法制造的。我们的高精度比较仪制造程序具有以下质量特点：

- 它们的设计符合DIN 879-1标准的要求。这不仅适用于尺寸，也适用于阅读误差、滞后和压力测量。
- 防震系统
- 机芯的小齿轮和轴都镶有宝石
- 拆卸安全帽后，外壳顶部的调节螺钉允许在整个测量范围内对仪器进行简单安全的零设置。
- 一个安全帽防止无意的转向微调设施。
- 阀杆和主轴由硬化不锈钢制成。
- 由于测量轴具有精确的导向，所以非常灵敏。
- 额外的超行程有助于工件插入测量装置。
- 清晰的刻度是无阴影的。
- 红色公差标记易于识别和设置。

The high precision comparator Gauges offer a high degree of security and precision.

They are based on a solid and well thought-out construction taking into account the latest technology.

They are manufactured by the most up-to-date methods. The following quality features characterize our manufacturing programme of Comparator Gauges Compika:

- Their design conforms to the requirements of DIN 879-1. This applies not only to the dimensions but also to permitted spans of error, hysteresis and measuring pressure.
- Effective shockproof system
- Pinions and shafts of the movement are jewelled
- After removal of the safety cap the adjustment screw on top of the case allows simple and safe zero setting of the instrument over the total measuring range.
- A safety cap prevents unintentional turning of the fine adjustment facility.
- Stem and spindle are made of hardened stainless steel.
- The measuring spindles are very sensitive on account of their accurate guides.
- Additional overtravel assists with the insertion of workpieces into the measuring device.
- The clear scale is shadow free.
- The red tolerance markers are easy to recognize and to set.

● GT 7601100

Antichoc

Lecture	0,001 mm
Course	0,1 mm
Course libre	3.0 mm
Pression de mesure	1,0 N
Ø extérieur	62 mm

Shockproof

Reading	0,001 mm
Range	0,1 mm
Over travel	3.0 mm
Initial measuring force	0,1 N
Bezel-Ø	62 mm

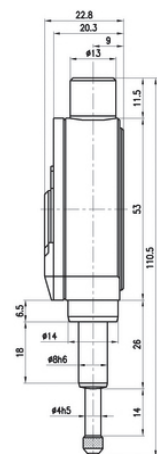

附件 ACCESSORIES



POS.	DESIGNATION	Type
1	旋转支架 Swivel support	GT. 3926
2	旋转支架 Swivel support	GT. 3925
3	可微调支架 Support with fine adjustment	GT. 3948
4	可持微调支架 Support with fine adjustment	GT. 3947
5	带有微调的旋转支架 Swivel support with fine adjustment	GT. 3944
6	带有微调的旋转支架 Swivel support with fine adjustment	GT. 3943
7	旋转夹 Swivel clamp	GT. 3917
8	棱柱形支架 Rectangular bar	GT. 3915
9	圆柱形支架 Cylindrical bar	GT. 3916
10	角度支撑 Angular support	GT. 3929
11	定心支撑 Centring support	GT. 3934
12	圆柱形柄 Cylindrical shank	GT. 3913
13	圆柱形柄 Cylindrical shank	GT. 3910
14	圆柱形柄 Cylindrical shank	GT. 3914
15	带磁性底座的旋转支架 Swivel support with magnetic base	GT. 3942
16	ø1点到接触面12mm Carbide contact point 12 mm, ø 1 mm	GT. 3321
17	ø2点到接触面12mm Carbide contact point 12 mm, ø 2 mm	GT. 3322
18	ø3点到接触面12mm Carbide contact point 12 mm, ø 3 mm	GT. 3323
19	ø1点到接触面36mm Carbide contact point 36 mm, ø 1 mm	GT. 3331
20	ø2点到接触面36mm Carbide contact point 36 mm, ø 2 mm	GT.3332
21	ø3点到接触面36mm Carbide contact point 36 mm, ø 3 mm	GT. 3333
22	探针更换工具 Key for contact point	GT. 3876

GIROD
INSTRUMENTS
www.vema.cn



VEMA
together for the future

WWW.VEMA.CN

亚洲区独家代理

VEMA Technology Co.,Ltd

南京众景科技有限公司
南京市溧水区徐母塘路307号
Tel: 025 8559 0128
Web: www.vema.cn
Mail: sales@vema.cn

GIROD-TAST



SWISS MADE